

**50HZ 60HZ**



**Product Features:**

- Through simple and convenient installation, we can connect the pump onto guide rail device. Whenever the pump needs maintenance, it can be easily pulled out through guide bar to dismantle, repair or examine the pump. For safety purpose, The workers no longer need to go down the septic tank to do maintenance. It will greatly reduce down time.

**Applications:**

- Animal husbandry and dairying septic tank waste water drainage; sewers, apartments, buildings and basements sewage treatment equipment drainage; Dye house, fur and leather industry and steel industry waste water drainage; other waste water treatments drainage.

**Installation Diagram:**

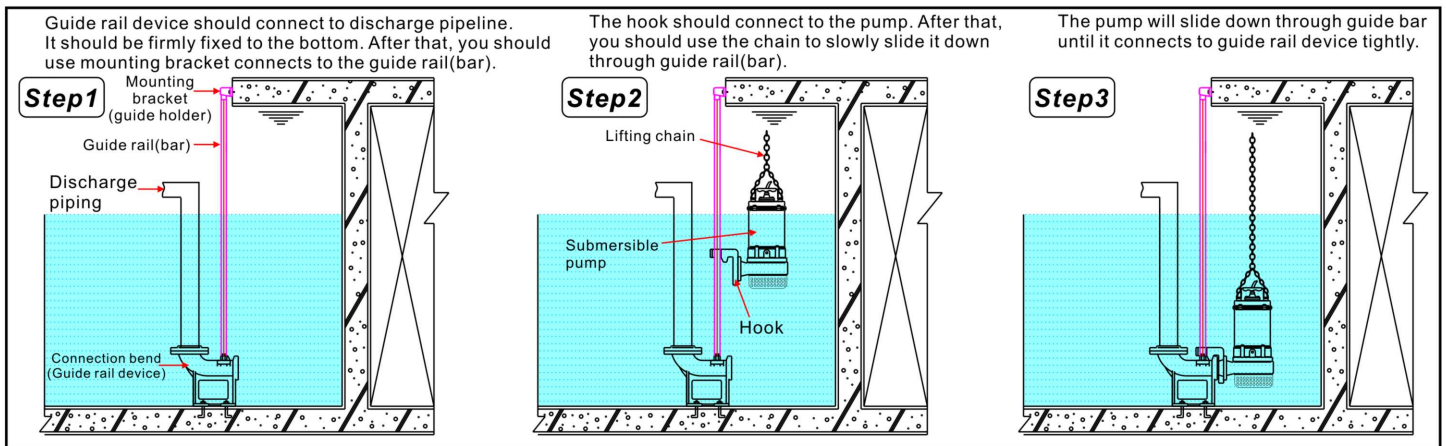

**Dimensions:**

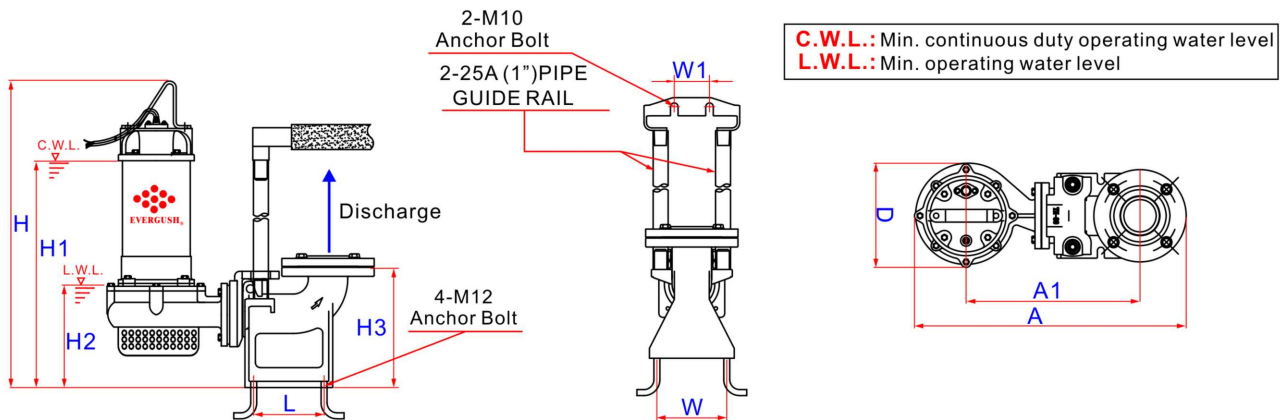

Model	Power	Disch.	Dimensions(mm)										Weight(KG)	
	HP	Inch	A	A1	D	H	H1	H2	H3	L	W	W1	TOS Device	TOS & PUMP
TOS-EA-05(T)	0.5	2"	490	311	173	469	356	172	243	110	140	70	16	29
TOS-EA-10(T)	1	2"	490	311	173	524	400	172	243	110	140	70	16	34
TOS-EA-20(T)	2	3"	564	368	210	601	453	175	243	110	140	70	16	50
TOS-EA-30T	3	3"	564	368	210	621	473	175	243	110	140	70	16	52
TOS-EA-50T	5	4"	730	520	230	718	553	245	310	160	150	70	24	80
TOS-EA-75T	7.5	4"	730	520	230	758	593	245	310	160	150	70	24	86

Remarks: ● TOS means cast iron guide rail device. (Q.D.C:Quick Discharge Device) ● "T" means 3 phase motor.