

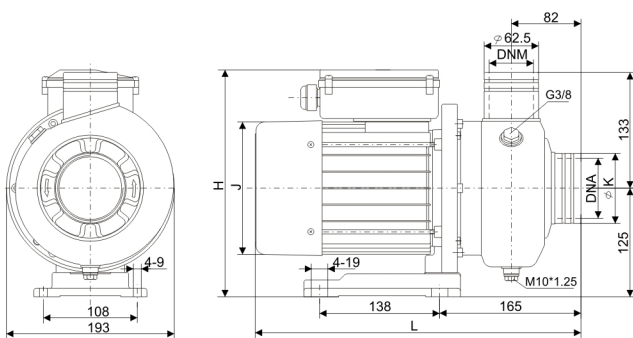

Technical data

1. 2P Induction motor
2. F Insulation
3. Protection: IP55
4. Single phase 220~240V/50HZ
Three phase 220~415V/50HZ
5. 1 phase motor built-in overload protector
6. Liquid Temp.: 0~+60°C
7. Working pressure: Max. 10bar
8. Solid passage: Max. 19MM

Dimensions



unit:mm

Applications

1. EDWK pump is suitable for conveying solid suspension in food processing.
2. Clean vegetable, meat and fish food.
3. Clean mental components, content..., etc.
4. Clean bottle, can, glassware..., etc.
5. Clean water storage tank, reservoir.
6. Circulation and cleaning system for assembly.
7. Swimming pool circulation system, drainage system, farmland irrigation, and booster system.

Features

1. Wet parts are made in stainless steel SUS304, to ensure delivering water clean and rustless.
2. Multi-purpose, transport a wide range of liquids.
3. Open type impeller design allows long fibrous materials and other solid to pass through, Max. solid passage: 19MM.
4. Mechanical seal for security and no leakage.
5. Connection mode: Thread, Hose connection.

Performance Curves & Table

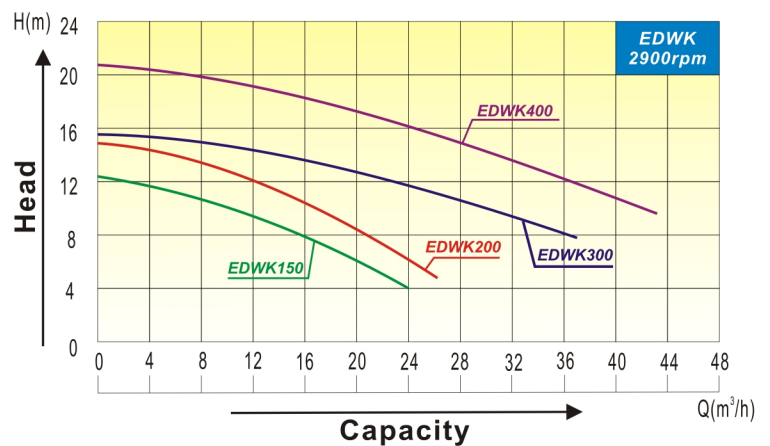

MODEL		J	L	H			K	DNA	DNM
Single phase	Three phase			Single phase	Three phase				
EDWK150	EDWK150T	155	378	265	235	62.5	G2	G2	
EDWK200	EDWK200T	155	378	265	235	62.5	G2	G2	
EDWK300	EDWK300T	169	415	242	242	80	G2 1/2	G2	
EDWK400	EDWK400T	169	432		242	80	G2 1/2	G2	

MODEL	Power	LPM	0	100	200	300	400	500	550	600	700
	HP	M³/H	0	6	12	18	24	30	33	36	42
EDWK150	1.5	M	12	11	9	7	4				
EDWK200	2		15	14	12	10	6				
EDWK300	3		16	15	14	13	11	10	9	8	
EDWK400	4		21	20	19	17	16	14	13	12	11